

Linear Actuator

The spindle actuator is ideal for economically controlling windows skylights and hatches for smoke control and ventilation applications.

General Specification

With a maximum stroke of 1000mm and a maximum force of 1500N it can be used to automate large and heavy panels. The motor is equipped with overload protection as standard and is smooth running and quiet in operation making it suitable for most commercial and industrial buildings.



Technical Data

Voltage	24 V DC
Nominal current	0.9 A up to 1.4 A
Cut off current	1.1 A, up to 1.5 A
Standard strokes	300, 500, 750, 1.000 mm
Max force	500, 1000, 1500 N
Cut off	Integrated or external (depending on version) electronic overload cut off and contact "F" for sequence controlling
Speed	500 N approx 8.4 mm/sec 1000 N approx 6 mm/sec 1500 N approx 3.8 mm/sec
Housing	Aluminium profile tube, anodized E6/EV1 with integrated bracket fixture
Length	309 mm + stroke + 21 mm cable and connectors
Protection class	IP 54
Switch on duration	ED 30 % respectively 20 % with 1500 N
Temperature range	- 5° up to + 75° C
Temperature resistance	300° C for 30 minutes according to DIN EN 12101/2
Connecting cable	Silicone 3 x 0.75 mm ² , light grey
Weight	Approx 3kg

Product Data

Code	Stroke Length	Force
M2 1701	300 mm	500N
M2 1702	500 mm	500N
M2 1703	750 mm	500N
M2 1704	1000 mm	500N
M2 1712A	300 mm	1000N
M2 1710A	500 mm	1000N
M2 1713A	750 mm	1000N
M2 1711A	1000 mm	1000N
M2 1714	300 mm	1500N
M2 1715	500 mm	1500N
M2 1716	750 mm	1500N

Linear Actuator

Brackets

Adjustable position of motor
Product code K2 1562

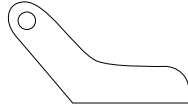

Upper Mounting Bracket
Product code K2 1501

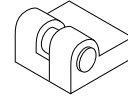

Mounting Bracket
Product code K2 1560 A

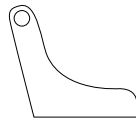

Quick Release Bracket
Product code K2 1502

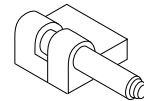

Rear Bracket Set
Product code K2 1539

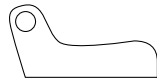

Upper Mounting Bracket
Product code K2 1500

